

CONFERENCES AND MEETINGS



"I CANNOT THANK YOU ENOUGH FOR THE EXCELLENT SERVICE WE RECEIVED ON THE DAY. ALL OF OUR STAFF HAD A FABULOUS TIME – THEY THOUGHT THE VENUE WAS ABSOLUTELY FANTASTIC. WITH VERY BEST WISHES."

Eversheds LLP

"I WANTED TO EXPRESS MY SINCERE THANKS TO YOU AND YOU TEAM FOR HELPING TO MAKE OUR EVENING TRULY MAGICAL. THE FOOD, AMBIENCE AND RUNNING OF THE EVENING WERE TRULY EXCELLENT; YOUR PROFESSIONALISM AND DEDICATION ARE SIMPLY SECOND TO NONE. WITH MY BEST WISHES."

Rachel Ley, MD, RLC Productions



A Superb New World-Class Conference Centre...

The Royal Welsh College of Music and Drama's new £22m suite of venues includes the magnificent Dora Stoutzker Concert Hall (250 - 350 seats), the intimate Richard Burton Theatre (182 seats), a large and flexible exhibition gallery accommodating up to 40 trade stands and a stunning glass-walled, three-storey high foyer and open-air terrace overlooking the Grade 1 listed Bute Park set in the grounds of Cardiff Castle.

In addition, our historic Anthony Hopkins Centre (the original Cardiff Castle Mews building) has a stunning open-air courtyard and a very impressive tree-lined avenue with Cardiff Castle in view.

These venues are available throughout the week from early July through to mid-September, December, January and during April.

Our conference venues also include:

- up to 14 break-out rooms;
- full technical support from a highly experienced in-house team;
- specialist lighting and sound;
- audio-video and wi-fi;
- full range of conference catering.

To create a memorable event with a difference, we can also organise musicians to perform for your guests such as a trumpet fanfare for the opening of your conference, a jazz pianist during your drinks reception or a sophisticated classical music ensemble during dinner.

Our beautiful park location is within a very short walk from the capital city of Cardiff with its magnificent shopping centres, Victorian arcades, historic theatres and museums, contemporary cinemas, a dramatic waterfront, luxury hotels, boutique guest houses and budget accommodation providers.

We would be delighted for you to view our venues in person. Alternatively take a tour on our website: www.rwcmd.ac.uk

For further information please contact:

Janet Smith
Venues Manager
Royal Welsh College of Music and Drama
Castle Grounds
Cathays Park
Cardiff CF10 3ER

02920 391376

janet.smith@rwcmd.ac.uk

www.rwcmd.ac.uk

"ONE HIGHLY RESPECTED MEMBER OF THE CONSERVATOIRE COMMUNITY FELT IT WAS THE BEST ORGANISED EVENT OF ITS SORT HE HAD EVER ATTENDED."

Professor John Wallace, Principal,
Royal Conservatoire of Scotland



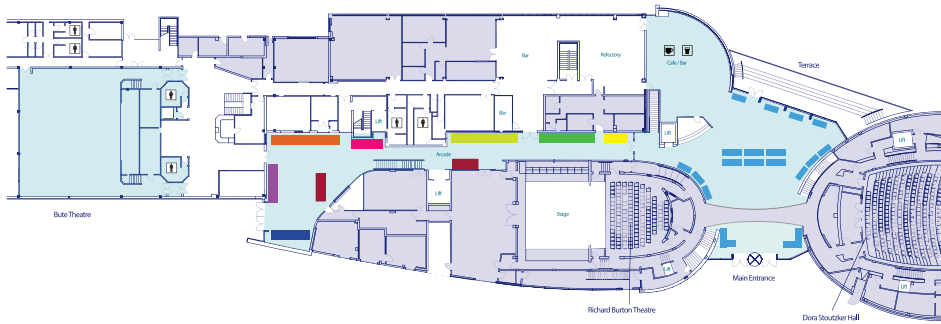

- Total exhibition area
- 8m frontage
- 7m frontage
- 6m frontage
- 5m frontage
- 4m frontage
- 3m frontage
- 2m frontage
- 2m x 13m frontage
- 13m frontage

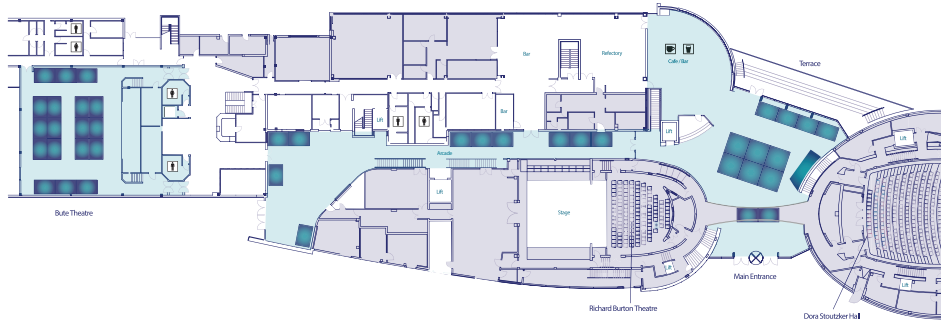

- Total exhibition area
- Shell scheme exhibition system 3x2m
- Shell scheme exhibition system 3x3m

Room	Dimensions	Total m2	Theatre-style	Cabaret-style	Reception	Boardroom
Foyer	23m x 24m (at its widest)	370	150	200	500	-
Dora Stoutzker Hall	Stage 14m x 9m (at its widest)	105	250 - 350	-	-	-
Richard Burton Theatre	Stage 12.5m x 9m	112	139 - 182	-	-	-
Linbury Gallery	4m (extending to 15m) x 65m	564	-	-	-	-
Bute Theatre	Stage 14m x 15m	210	160	140	300	-
Seligman Studio	10m x 12.5m	125	60	60	60	30
Simon Gibson Studio	10m x 12.5m	125	60	60	60	30
Rowe-Beddoe Studio	9m x 13m (at its widest)	117	60	60	60	30
Studio 1	9m x 13.5m	121.5	60	60	60	30
Studio 2	11.5m x 8.5m	98	60	60	60	30
Weston Gallery	13m x 6m	78	80	50	80	30
Corus Recital Room	10m x 6m	69	50	30	50	20
Sir Geraint Evans Recital Room	17m x 9m	153	80	60	80	30
Room 206	10m x 9m	96	60	-	60	30
Room 208	10m x 9m	92	50	-	60	30

“YOUR EFFORTS WERE A SPECTACULAR SUCCESS AND SHOWED OFF THE COLLEGE TO GREAT ADVANTAGE. I BELIEVE THAT THE 2012 BUFDG CONFERENCE WILL GO DOWN IN HISTORY AS ONE OF THE VERY GREAT CONFERENCES - SO THAT THOSE ATTENDING THE 2032 CONFERENCE WILL STILL BE RECALLING THIS ONE.”

Miles S Hedges, Finance Director,
The Open University



Does the College provide all the catering?

Yes. Our highly-recommended in-house caterers, Catering Academy offer refreshments, hot and cold buffets, reception and bar drinks, canapés and formal banquets to suit all budgets – hot and cold buffets begin around £6 per head, simple refreshments from around £1.50 and three-course dining from around £30 per head (including VAT).

Do you have any discount arrangements for overnight accommodation in the city?

Our unique park location is within a short walk from the centre of the capital city of Cardiff with its luxury hotels, boutique guest houses and budget accommodation providers.

Jolyon's at No. 10 (www.jolyons10.com) is conveniently located just a short walk from the College and houses 21 stylish rooms with an eclectic mix of bespoke furnishings and Japanese-style plunge baths. The hotel's restaurant serves up a delicious menu of locally sourced produce, while the

Cwtch Mawr (Big Cuddle) bar provides the perfect place to relax and unwind. Bed and breakfast accommodation is from £80 for single rooms, £99 for deluxe double rooms and £125 for suites. Further discounts apply to group bookings of 10 rooms or more. Contact General Manager Carl Davies 029 20091 900 or carl@jolyons.co.uk and quote the Royal Welsh College of Music and Drama.

Alternatively, overnight accommodation in the capital city's hotels and guest houses can be arranged at very competitive rates through the Cardiff Convention Bureau. Contact Heledd Williams, Head of Cardiff Convention Bureau at Heledd.Williams@cardiff.gov.uk 029 2087 1846/1028.

Our student accommodation provider, Liberty Living is an eight minute walk from the College. Their price is around £25 per night per person. Whilst this accommodation is not serviced, it is of very high quality. Contact Rebecca Evans 02920 227615 or r.evans@libertyliving.co.uk

Is there parking on-site?

Whilst car parking at the college is restricted to blue-badge holders only, there are pay-and-display car parks adjacent to and opposite the college (free after 6pm). In addition, there are many city centre multi-storey car parks 5-10 minutes walk from the college.

What are the venue hire costs?

Venue hire charges begin from around £150 plus VAT for small meetings and from £600 plus VAT for larger venues depending on the duration of hire, the number of rooms and technical support required. All quotes are subject to contract.

How much would music or other entertainment cost?

Costs for our musicians and performers begin at approximately £170 plus VAT per musician playing for up to two hours.

